

# CARRO ARMATO M13/40 OR M14/41 & SEMOVENTE 75/18 ASSEMBLY AND PAINTING GUIDE



The Carro Armato M13/40 was an Italian World War II tank designed to replace the M11/39 in the Italian Army at the start of World War II. It was the primary tank used by the Italians throughout the war. The design was influenced by the British Vickers 6-Ton and was based on the modified chassis of the earlier M11/39.

The name refers to 'M' for *Medio* (medium) according to the Italian tank weight standards at the time, 13 tons was the scheduled weight and 1940 the initial year of production.

The M13/40 was used in the Greek campaign in 1940 and 1941 and in the North African Campaign. The M13/40 was not used on the Eastern Front, Italian forces there were equipped only with L6/40s and Semovente 47/32s. Beginning in 1942, the Italian Army recognized the firepower weakness of the M13/40 series and employed the Semovente 75/18 self-propelled gun alongside the tanks in their armoured units.

## Carro Armato M13/40 and M14/41

**No. produced:** 2000

**Crew:** 4

**Powerplant:** SPA 8 T M40 11,140 cc V8 diesel  
125 hp (93 kW)

**Top speed:** 231.8 km/h (19.8 mph) on road

**Range:** 200 km (120 mi)

**Armament:** 1 x cannone da 47/32 47 mm AT gun,  
4 x 8mm Breda machine guns  
(1 x coaxial, 1 x AA, 2 x in hull)

**Armour:** Front: 30 mm (1.2")  
Sides/rear: 25 mm (0.98")  
Floor/roof: 6–14 mm (0.24–0.55")  
Turret front: 42 mm (1.7")

**Weight:** 10.7 tons

## ASSEMBLY GUIDE KEY



## Assembly stage



Do not glue

22

Part number



Previous assembly stage



## Special assembly instructions



Decal number



## Optional assembly



Drill part

987

Paint number (Vallejo)

Follow this simple guide to build your Carro Armato M13/40 or M14/41 or Semovente 75/18.

Carefully remove each component from the frame with clippers or a craft knife. Trim off excess plastic before assembling. Test fit all parts before applying glue.

**We recommend using polystyrene cement to assemble the kit, and to use this in a well-ventilated area.**

Keep tools, glues, paints and small components away from children. Warlord Games recommend this kit for ages 14 and over.

## DECAL APPLICATION GUIDE

- Apply a coat of gloss varnish to the areas that will receive the decal and allow this to dry fully.
- Cut out a decal from the sheet and soak it in luke warm water for 2-3 minutes.
- Once the design has started to separate from the backing paper, use tweezers or a wet paintbrush to slide the design into place on the model.
- Use a tissue to dab away any excess water from the model, and allow to dry.
- Apply a coat of matt varnish to seal the decal in place.

Australian army markings  
(captured vehicles)

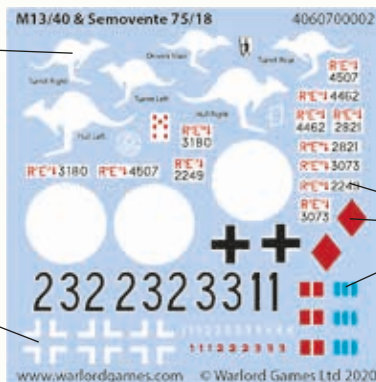

### Italian army markings

## German army markings

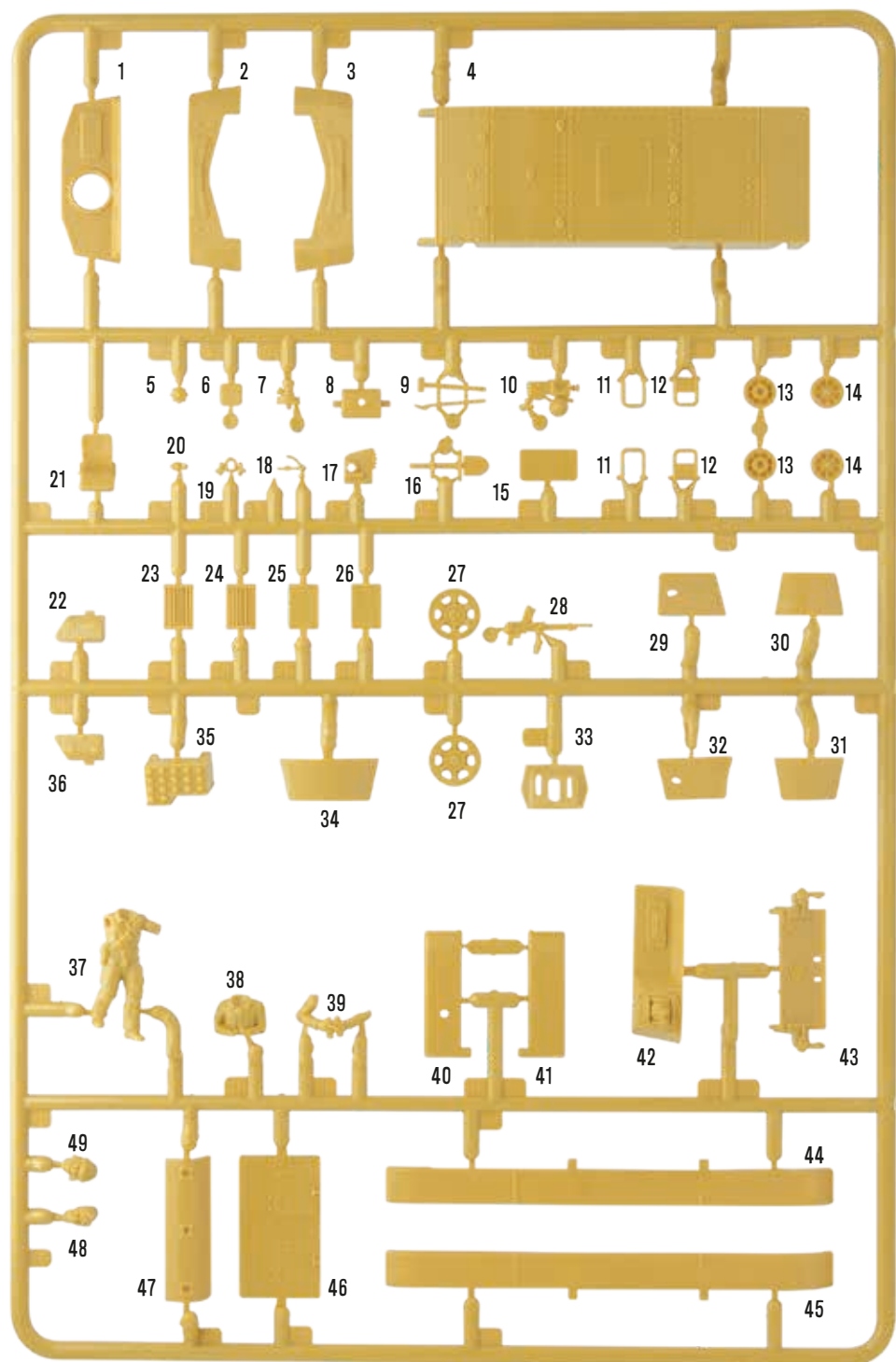

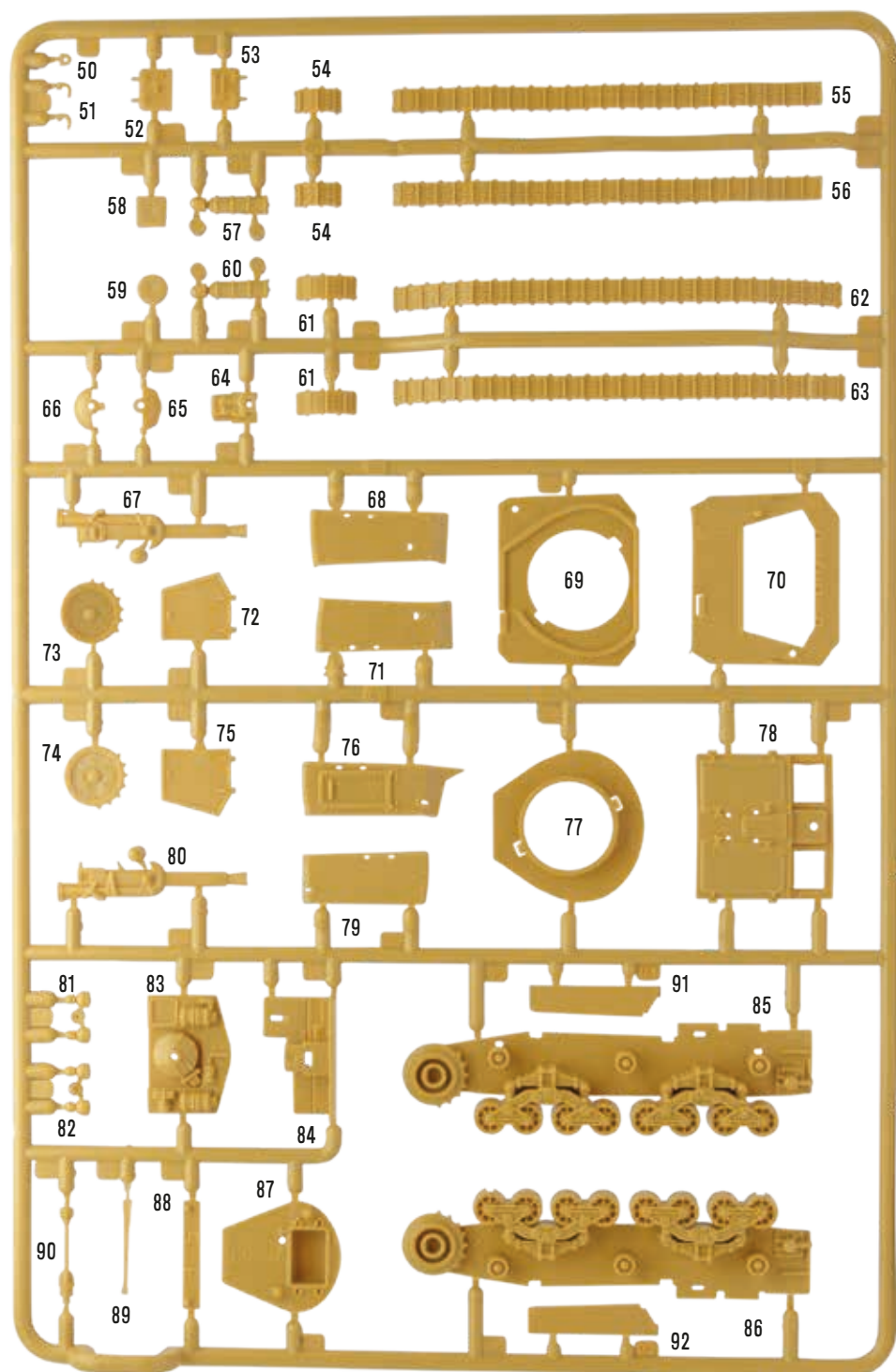



A

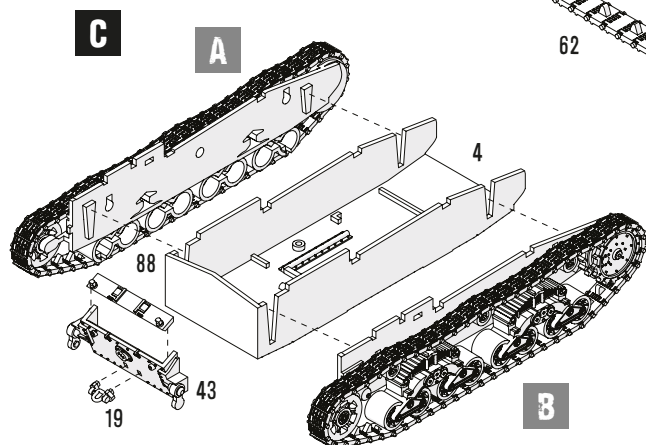
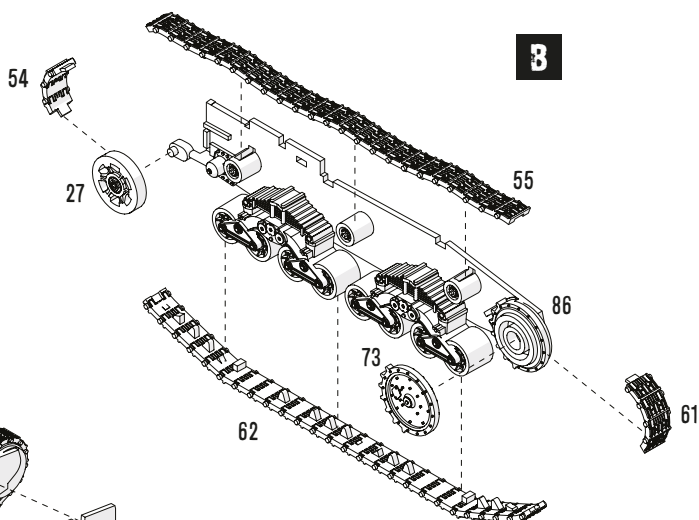
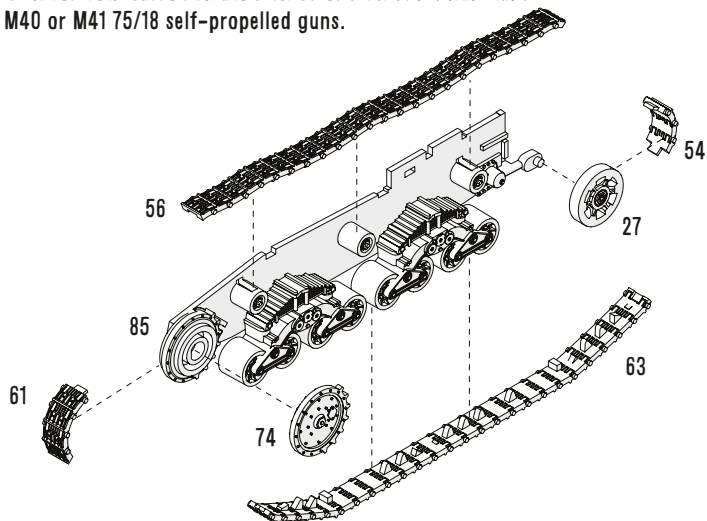

**D**

Front

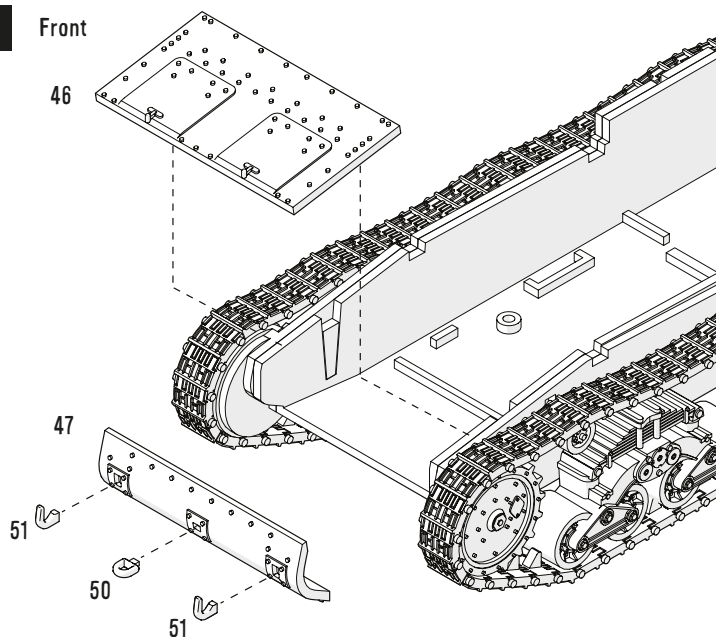
**E**

Rear

? For medium tank and Semovente M40 chassis.

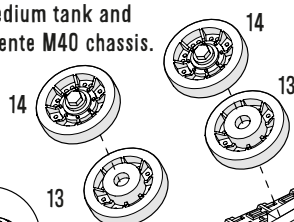

? Remove pin.

For medium tank and Semovente M41 chassis.

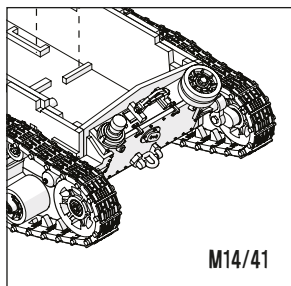

Semovente 75/18 M40 or M41 self-propelled gun.

F

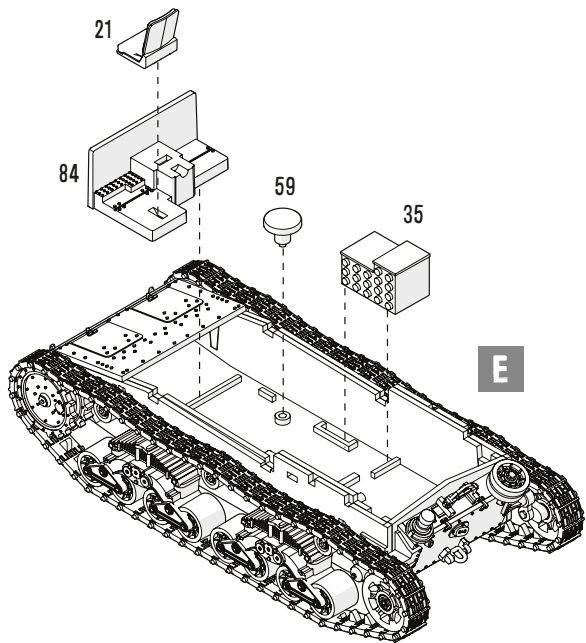

Semovente 75/18 M40 or M41 self-propelled gun.

G

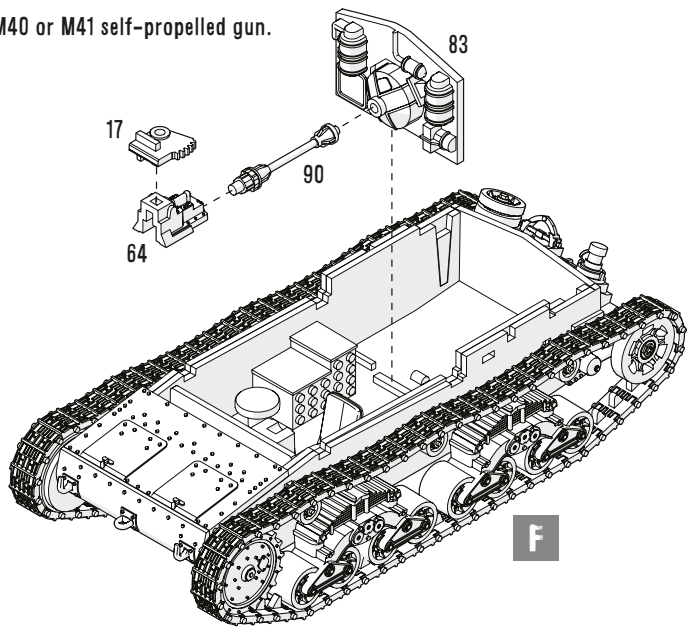

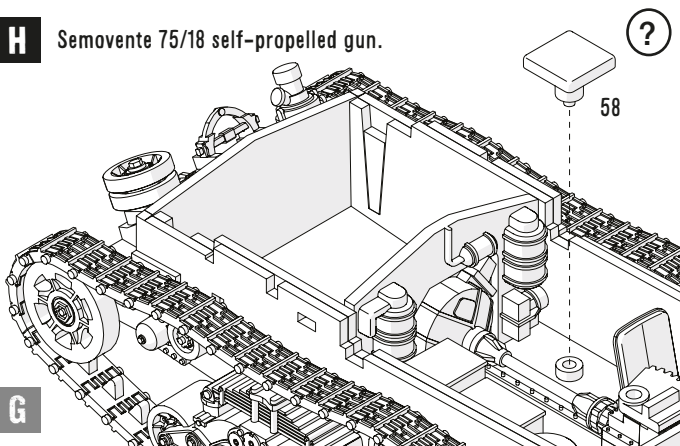
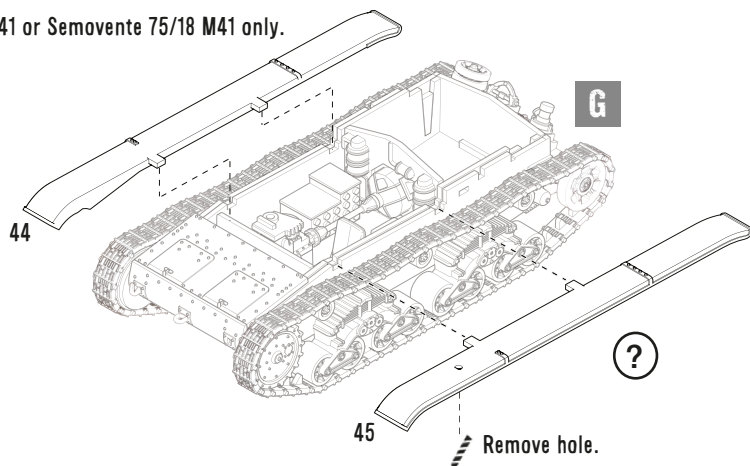
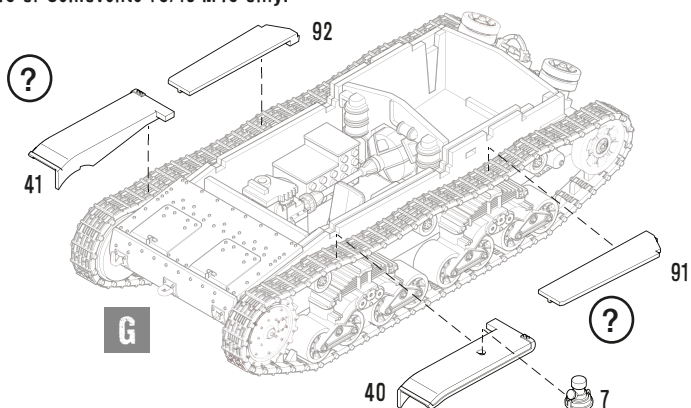
**H****Semovente 75/18 self-propelled gun.****G****I<sup>A</sup>****For M14/41 or Semovente 75/18 M41 only.****G****I<sup>B</sup>****For M13/40 or Semovente 75/18 M40 only.****G**

**J**

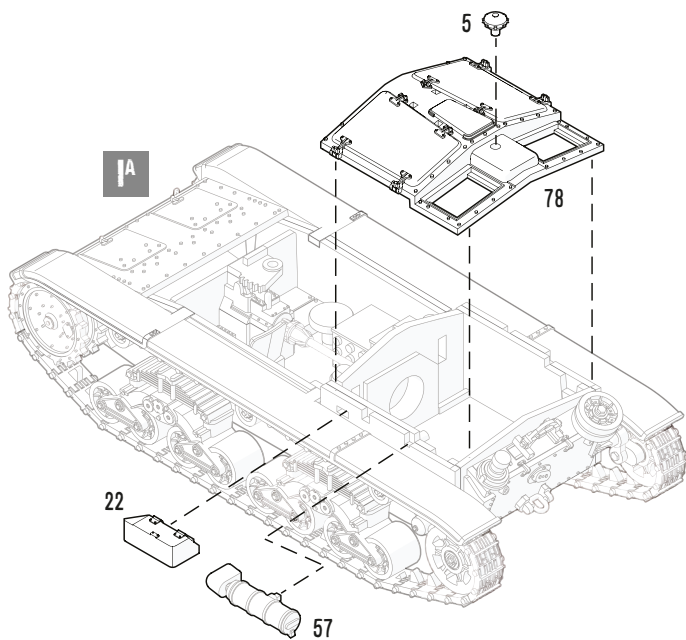

**K**

25-26  
For M40 variants only.

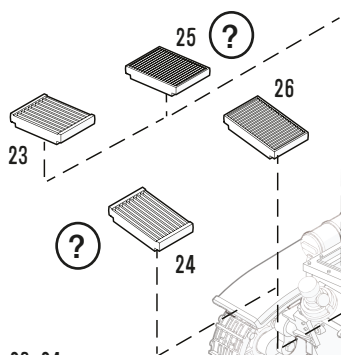

23-24  
For M41 variants only

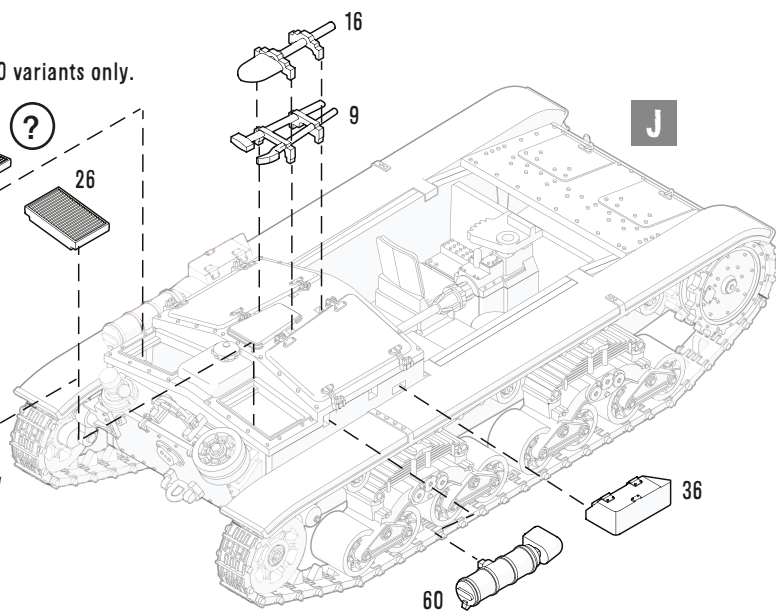

**J**



Follow stages L-S for Carro Armato M13/40 or M14/41 medium tanks only.

**L**

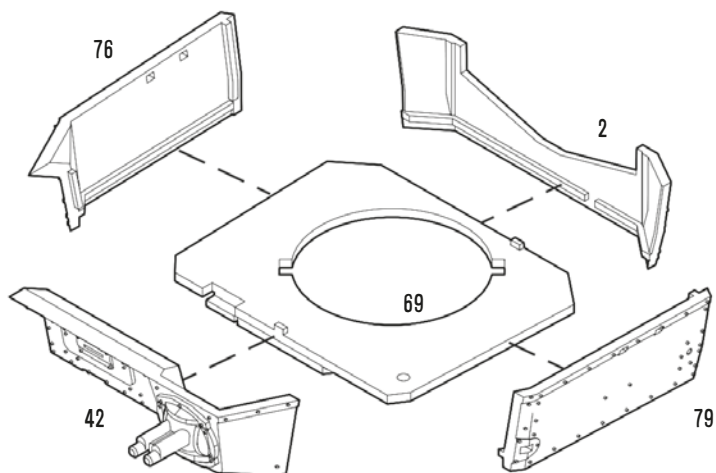

**M**

**L**

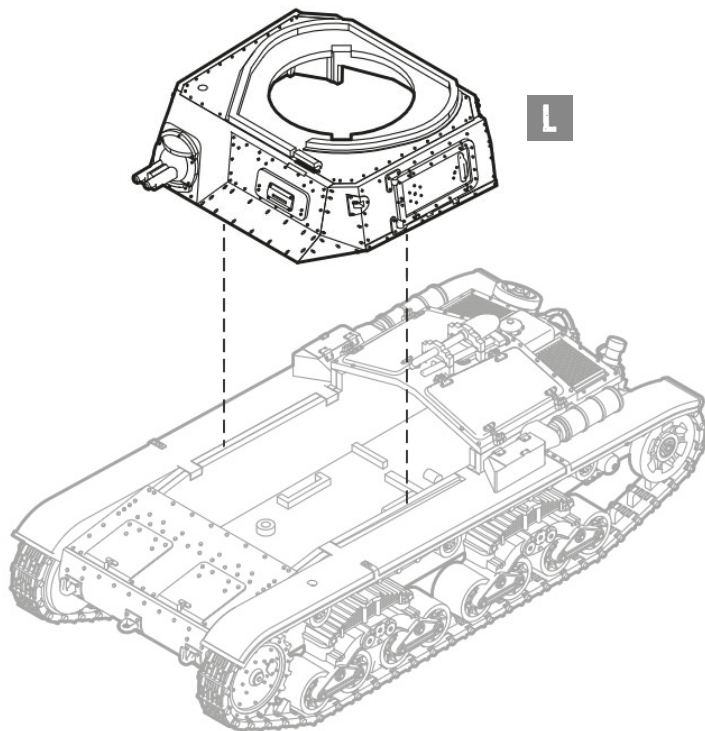

**N**

20

**M**

11 - M14/41  
variant only.

12 - M13/40  
variant only.

81

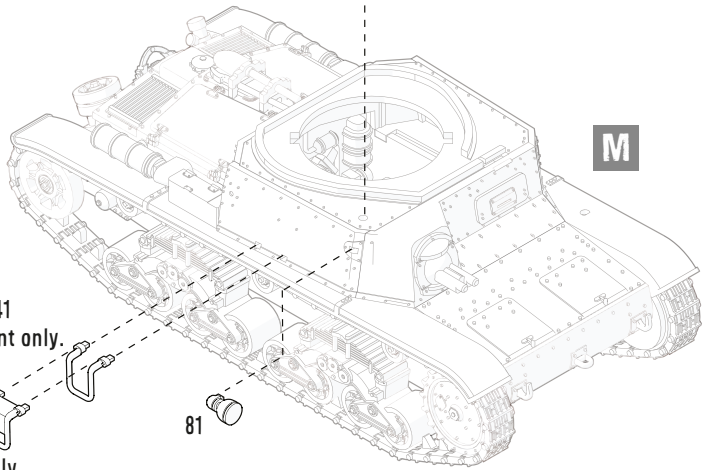

**924 Russian Uniform 50%**



**894 Camo Olive Green 50%**



Italian army Carro Armato M14/41 in in single tone scheme -  
Albania, March 1941.

Carro Armato M13/40 and M14/41 only.

**0**

**?**  Drill holes for M14/41 variant.

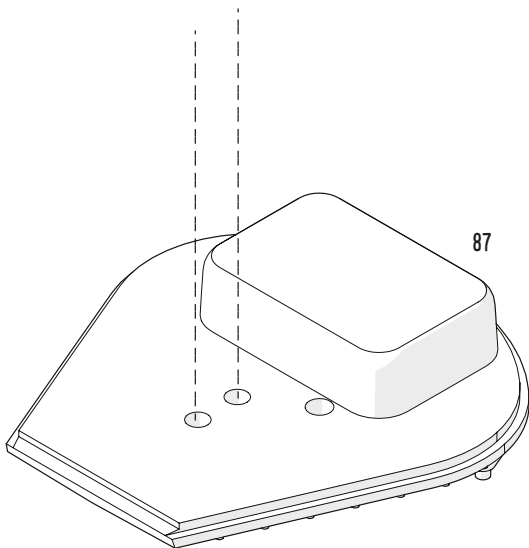

Carro Armato M13/40 and M14/41 only.

**P**

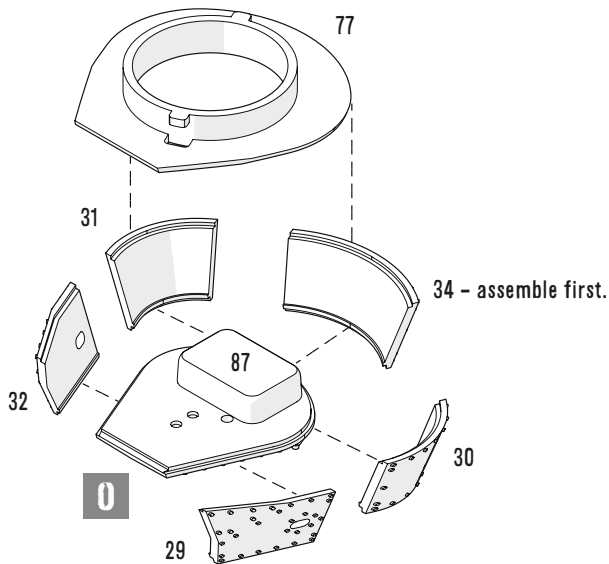

Q

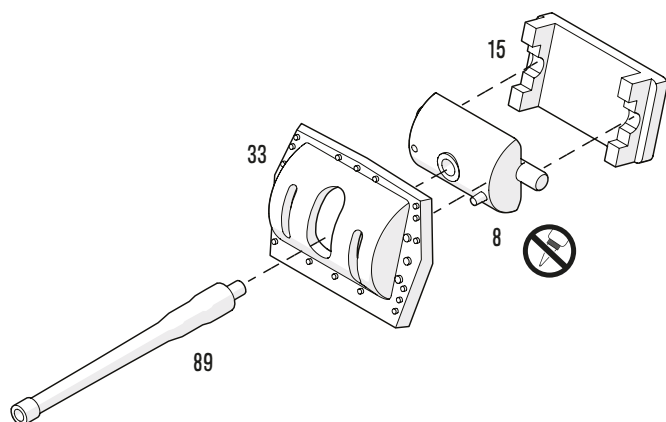

**R**

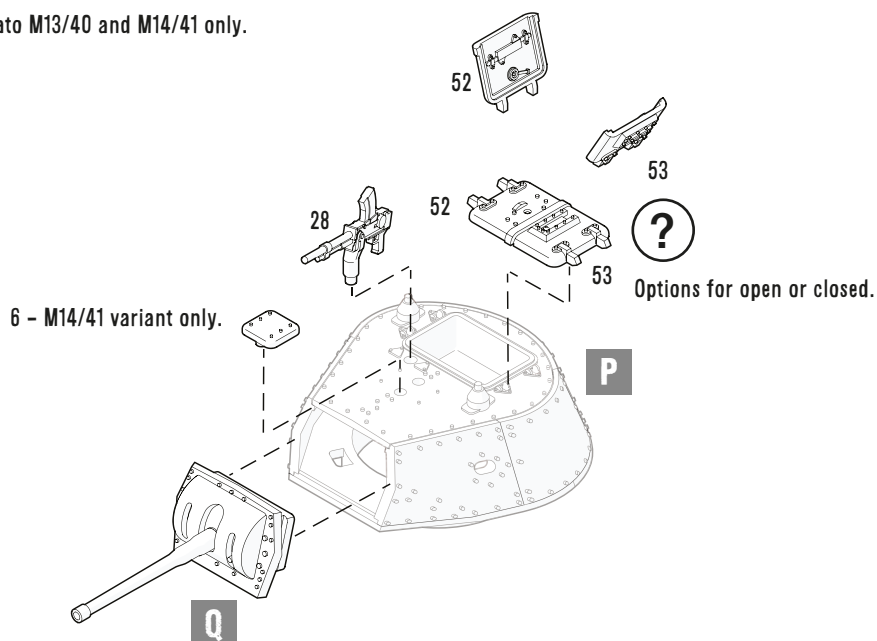

Carro Armato M13/40 and M14/41 only.

S

R

?

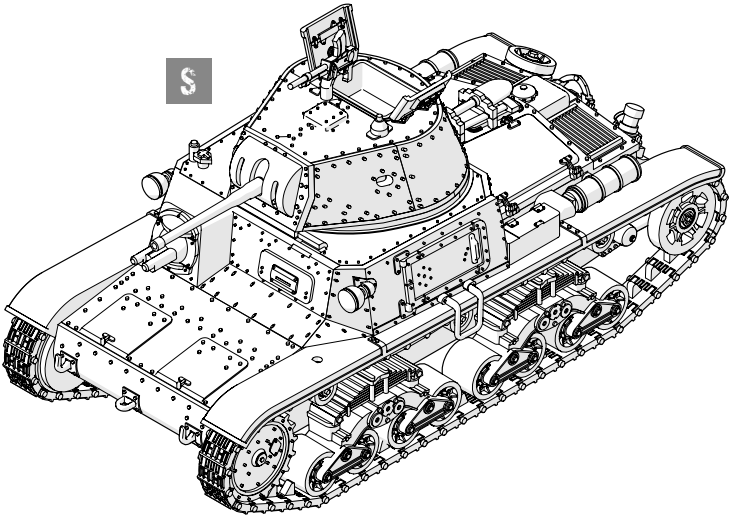
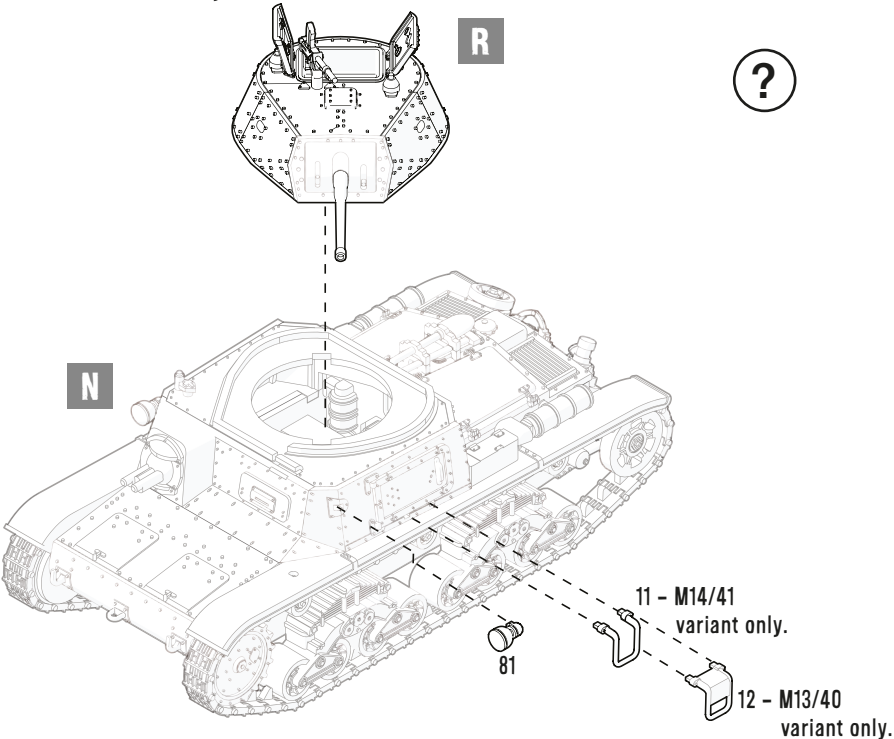



Follow stages T-X for Semovente 75/18.

T

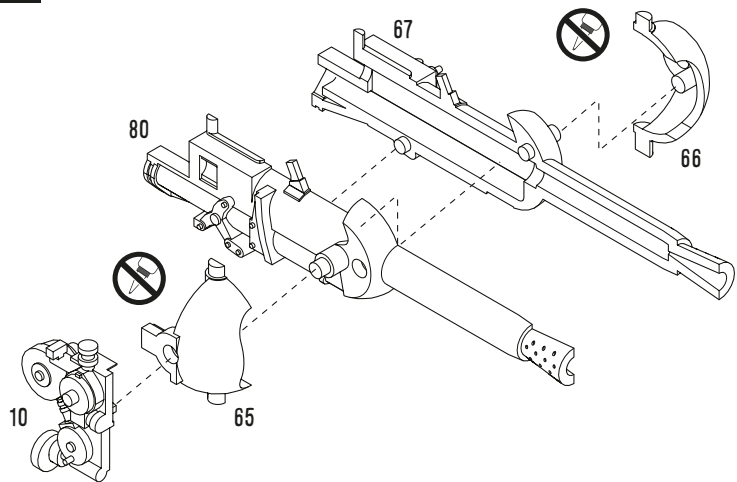

U

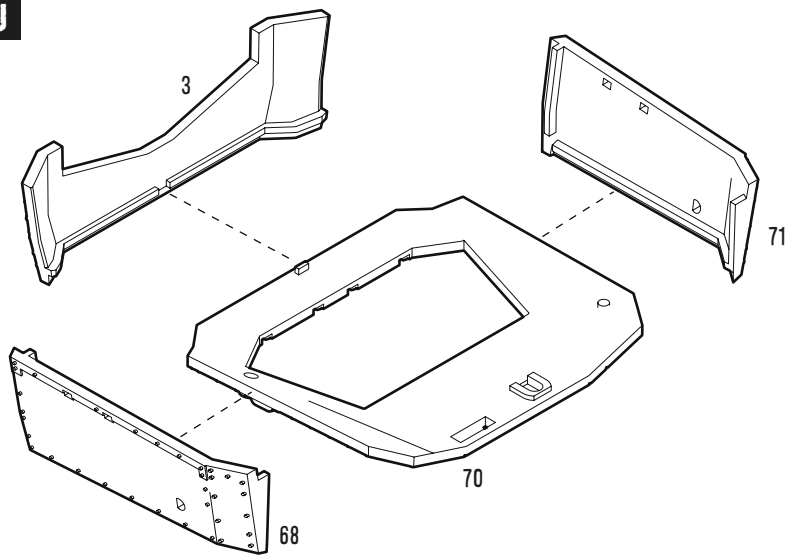

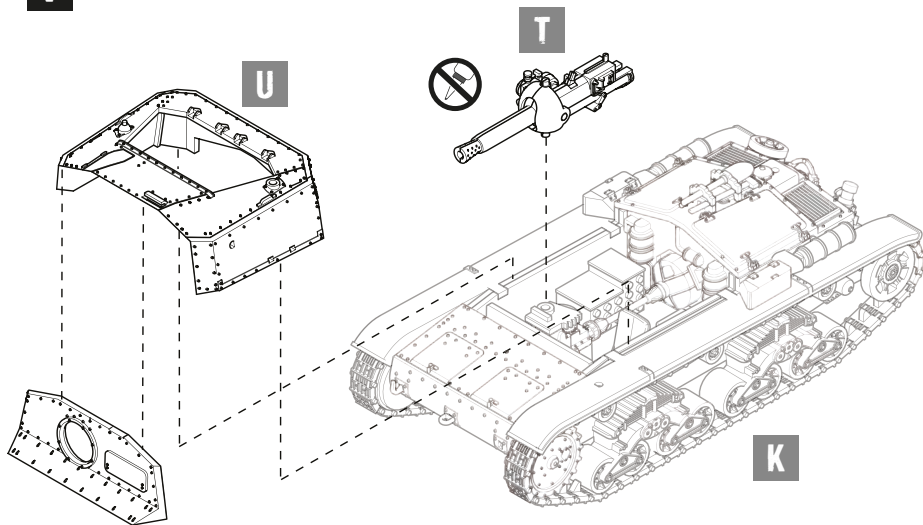
**V**

1 Attach part 1 after stages U and T are in place.

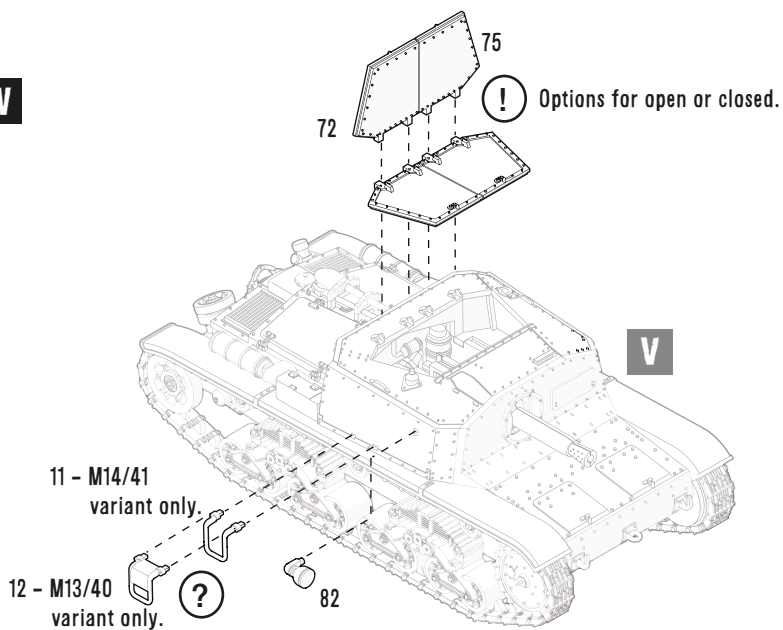

**W**

Semovente 75/18 SP gun only.

X

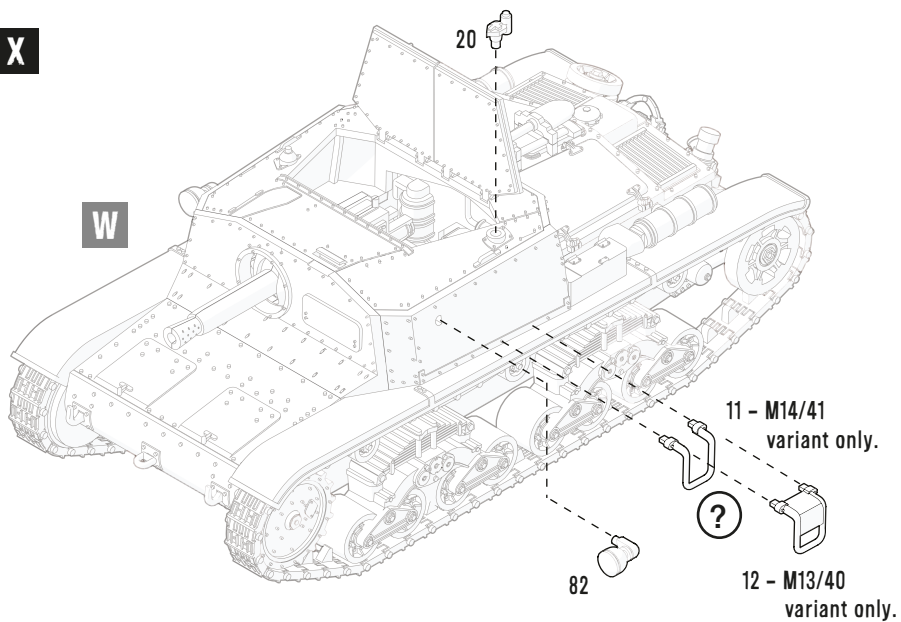
W



	824 German Camo Orange Ochre
	872 Chocolate Brown
	894 Camo Olive Green



Italian army Semovente 75/18 in three tone camouflage - Italy, September 1943.

# CREW ASSEMBLY

## COMMANDER - CARRO ARMATO M13/40 AND M14/41

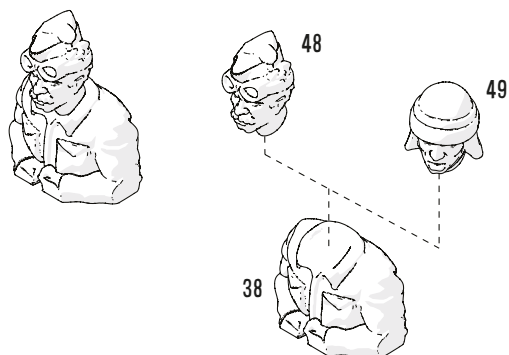

## COMMANDER - SEMOVENTE 75/18 SP GUN

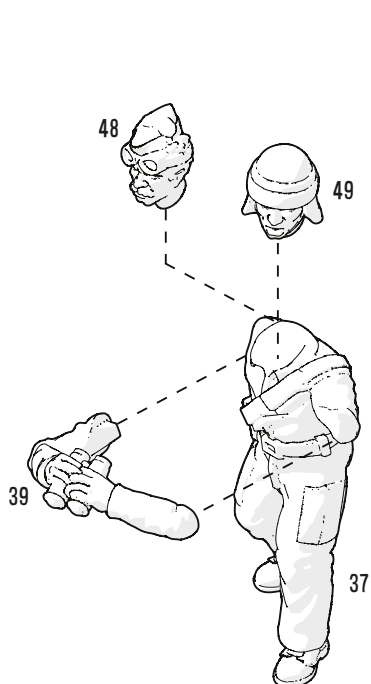

# CARRO ARMATO M13/40 OR M14/41 MEDIUM TANK



824 German Camo Orange Ochre



894 Camo Olive Green

Italian army Carro Armato M13/40 in  
two tone camouflage -  
El Alamein, North Africa 1942.





# SEMOVENTE 75/18 SELF PROPELLED-GUN

824 German Camo Orange Ochre

Italian army Semovente 75/18 in desert scheme -  
Tunisia, 1943.

820 Off White



Component code: 4070700002